

Manufacturers Recommended Metal Roofing Fastening Guide

with < 20'-0" mean roof height – 2/12 to 12/12 pitch for
120-150 mph wind speeds

26GA. 5V-CRIMP FASTENER SPACING FOR OVER PLYWOOD						
ZONE	FASTENER	SUBSTRATE	WIND SPEED ZONE			
			120	130	140	150
			ON CENTER SPACING	ON CENTER SPACING	ON CENTER SPACING	ON CENTER SPACING
ZONE 1	#10 x 1 1/2"	15/32" CDX/ 19/32" CDX	12"	12"	12"	12"
ZONE 2	#10 x 1 1/2"	15/32" CDX/ 19/32" CDX	12"	12"	12"	12"
ZONE 3	#10 x 1 1/2"	15/32" CDX/ 19/32" CDX	6"	6"	6"	6"

PANEL DESCRIPTION: 5V-CRIMP, MIN. 26 GA. GRADE 50, 24" COVERAGE, 3/8" TALL.

PANEL FASTENER: (1) #10 X 1-1/2" WOOD SCREW W/WASHER

MAXIMUM ALLOWABLE PANEL UPLIFT PRESSURE: 108.5 PSF @ 12" FASTENER SPACING, 156.5 PSF @ 6" FASTENER SPACING BASED ON TAS 125, UL 580/UL 1897 TESTING.

PLYWOOD DECKING: MIN. 15/32" PLYWOOD. PLYWOOD MUST BE DESIGNED IN ACCORDANCE WITH FBC 2004.

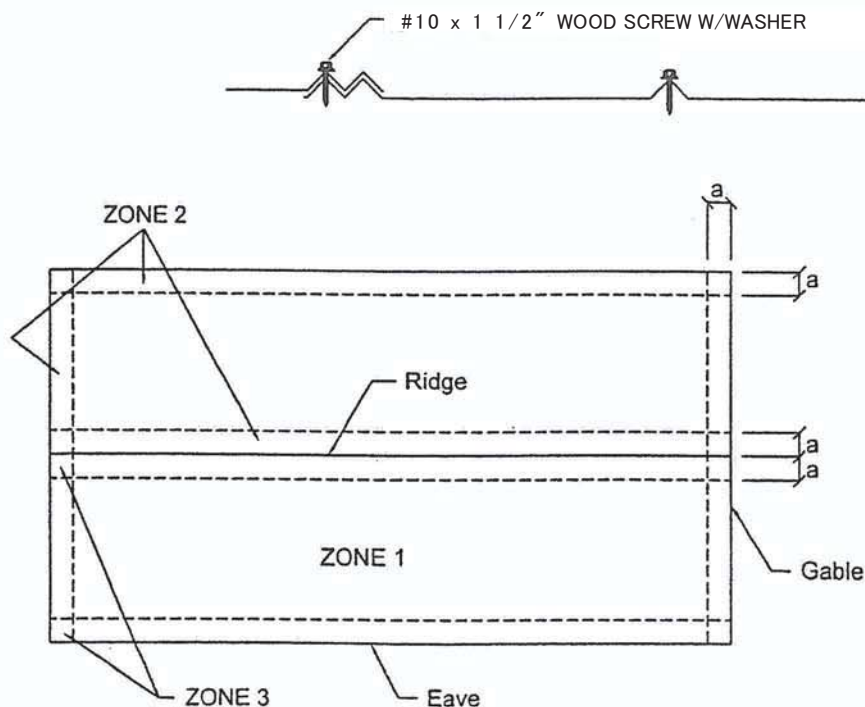

NOTE: Dimension (a) is defined as 10% of the minimum width of the building or 40% of the mean height of the roof, whichever is smaller, however, (a) cannot be less than either 4% of the minimum width of the building or 3 feet.